

# Classics™ 1" Cordless Aluminum Blinds

## PRODUCT SPECIFICATIONS

**Headrail** shall be 1" high x 1-1/2" wide x .025" thick U-shaped steel. The steel finishing process includes phosphate treatment for corrosion resistance, a chrome-free sealer, a low hazardous air pollutants (HAP) urethane primer, and a topcoat of low HAP polyester-baked enamel.

**Tilter** shall be made of injection-molded thermoplastics for smooth low-friction operation and shall incorporate a clutch mechanism to prevent damage due to overtilting.

**Tilt Rod** shall be electro-zinc coated solid steel.

**Tilt Wand** shall be clear polycarbonate with a hexagonal cross section measuring approximately 1/4" diameter and attached to the tilter shaft by means of a polycarbonate hook for easy removal.

**Drum and Cradles** shall be low-friction thermoplastic and provided for each ladder.

**Installation Brackets** shall be made of phosphate-treated steel with a urethane primer and polyester-baked enamel finish to match headrail. The design shall incorporate a hinged front cover.

**Braided Ladder** shall be made of 100% polyester yarn, incorporating two extra-strength rungs per ladder for slat support. Standard ladder spacing shall be 21.5 mm.

**Slats** shall be 5000 series cold-rolled aluminum containing the maximum allowable recycled content to produce a high-strength and corrosion-resistant flexible product. Slats shall be nominally 1" wide x .006" thick and processed to provide a smooth, hard, less porous surface with antistatic performance to repel dust. Slats shall be treated with a topcoat of low HAP polyester-baked enamel.

**Bottomrail** shall be a completely enclosed tubular shape made of phosphate-treated steel for corrosion resistance and finished with a chrome-free sealer, low HAP urethane primer, and a topcoat of low HAP, polyester-baked enamel. Bottomrail shall measure .025" thick.

## OPTIONS

- Cordless lift or Tilt only
- .006" thick slat (.008" optional)
- Inverted slat for daylighting
- Tilt limiter (tilt only)
- Ring tilt
- Turn clips for extruded pocket
- Extension brackets
- Hold down brackets
- Cut-outs (tilt only)
- Two-slat valance
- Deluxe two-slat valance
- Specialty shapes (arches, circles, and angles) available as tilt only

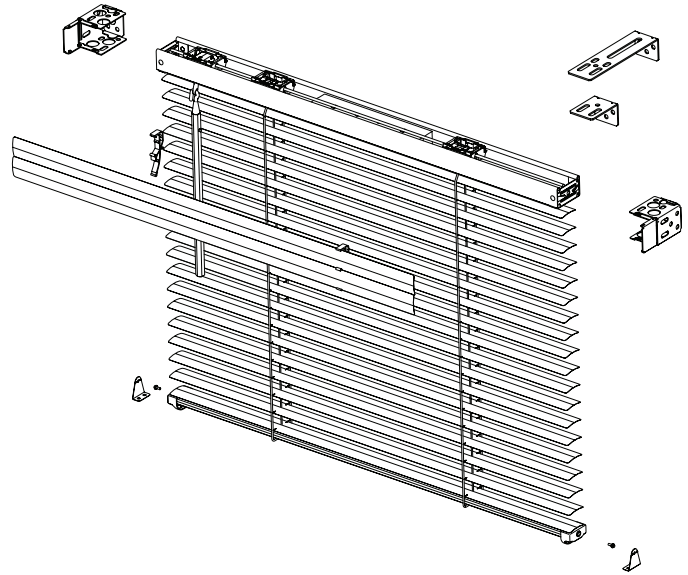

## PRODUCT FEATURES AND BENEFITS

- Cost-efficient, durable performance
- Extra heavy-duty steel 1" x 1-1/2" headrail allows greater blind widths or up to three blinds on one headrail
- Enclosed bottomrail
- Box bracket
- Compliant with ANSI/WCMA A100.1-2022 Standard
- Antistatic performance to repel dust
- Low HAP, low VOC paint process
- Slats meet NFPA 701
- Limited lifetime warranty